

View on 'A'

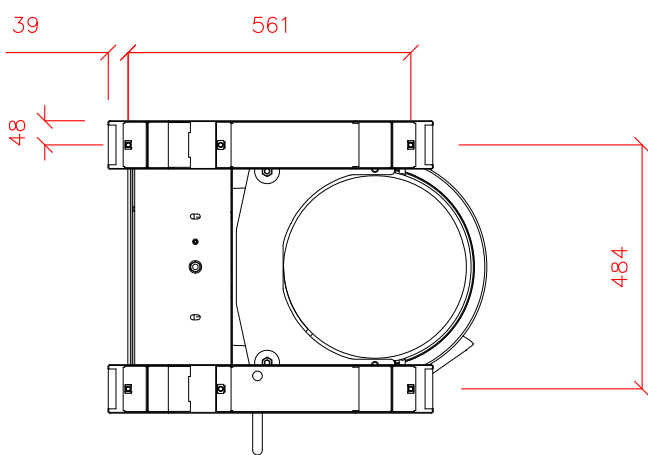

View on 'B'



- | | |
|----------|--|
| 1 | Electric - (3 Phase Supply)
1.1kW - 400/50/3 Recommended to be fused at 10amps |
| 2 | Weight
Mixer weight including agitator and bowl (empty) - 204kg
Shipping weight (on wooden pallet) - 222kg |